

EPiC Seating

Effortless | Postural | Control



B | E | S
HEALTHCARE

0117 966 6761
info@beshealthcare.net
www.beshealthcare.net



Introducing EPiC Seating

The revolutionary new postural management system

Postural variation is a necessity for functional seating and currently there has been no system on the market addressing this need fully. We all move, whether it's at a micro or macro level. We all move to accommodate functional activities such as pressure off-loading, fatigue management, digestion, respiration, or peer interaction. EPiC Seating allows for postural changes throughout the day as required to support these functions.

Advantages

- Anatomical pivot point** originating from the client as opposed to the frame. The rotation occurs around the pelvis instead of from the seating hardware.
- Tool-less adjustment** for carers to change their client's position quickly and easily to support their functional needs. Back angle and range of movement can be adjusted without the need for tools.
- 'Active' setting** provides independent relief, allowing the client to move freely through a range of angles and find the postural position that maximizes their functional capability. The system can return to neutral without caregiver's help.

Back Support and Head Support not included.
Most after-market back supports that can be mounted with a 1" (2.5cm) cane clamp hardware will fit your new EPiC seating.

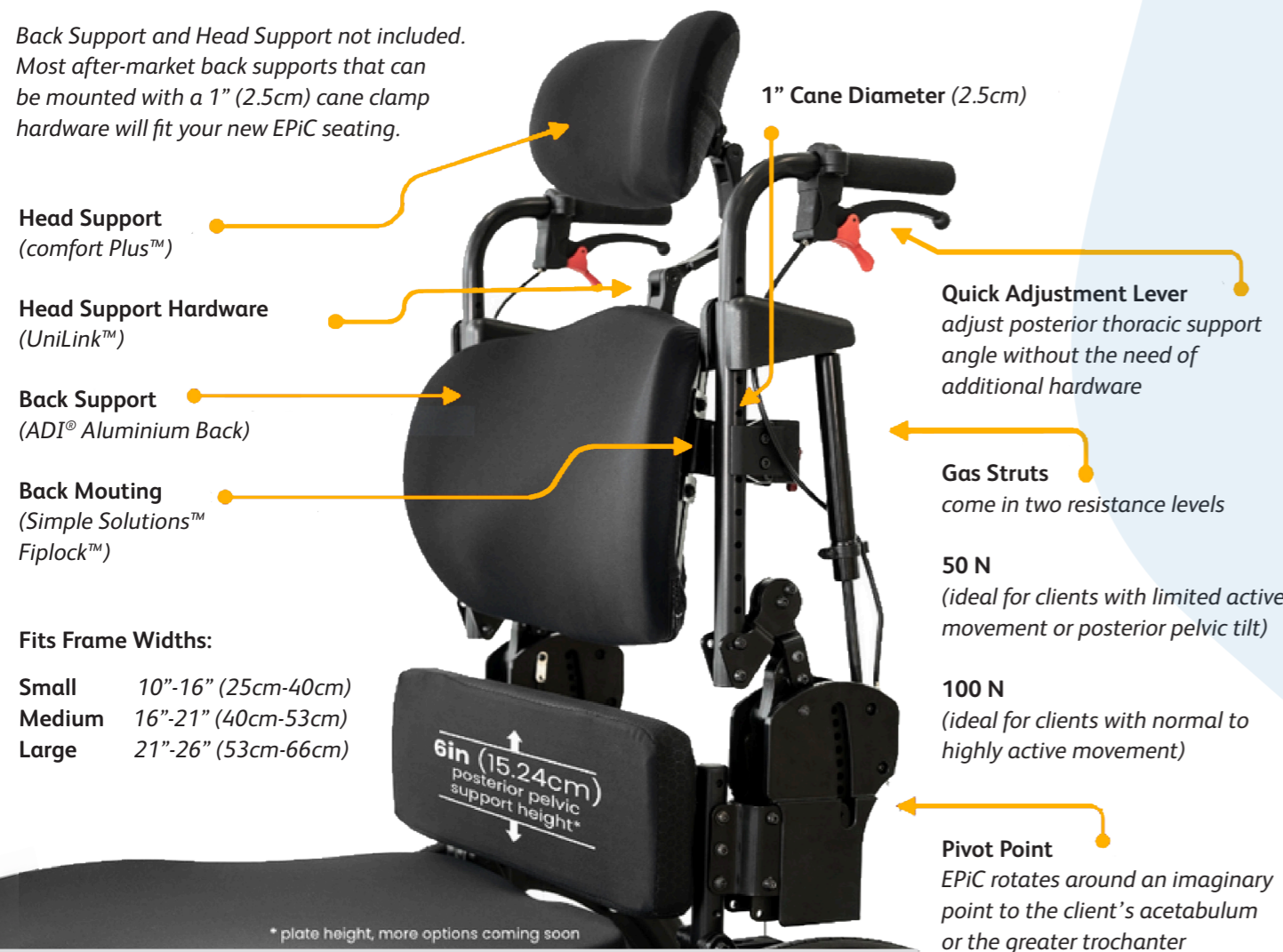

* plate height, more options coming soon

more options coming soon

Current Reclining Systems

- When the back support reclines, the back slides upward relative to the client's body causing friction and shear forces.
- Sliding occurs at the pelvis when the back support is returned to a neutral position, creating friction and shear forces at the seat surface.
- During a recline, secondary supports such as head and lateral supports also move in conjunction with the back support, requiring readjustment.

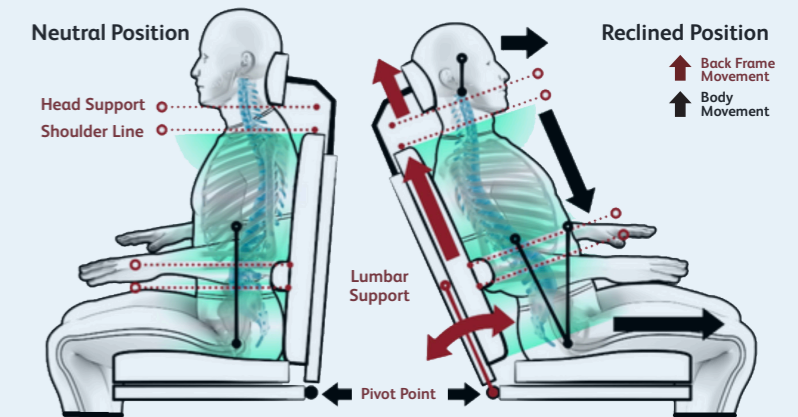

Current Tilt-in-space Systems

- Clients looking at the ceiling for extended periods of time due to the system tilt causing change in body and head orientation.
- Development of postural accommodation to adjust their line of sight like trunk and/or neck flexion, causing complex problems overtime.
- On relaxation, the lumbar support can contribute to pelvic migration during recline. The non-anatomical pivot point can encourage the pelvis to rotate backwards and slide forwards.

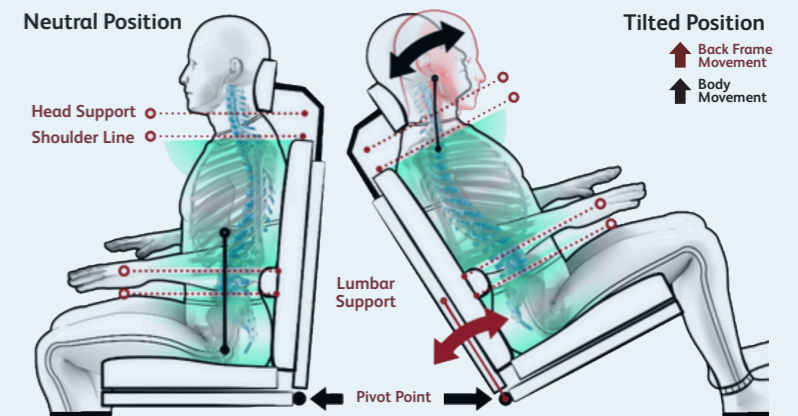

New EPiC Seating Solution

- Incorporates an angle/height adjustable stationary pelvic support with a moveable thoracic back support.
- Incorporates an anatomical pivot point which helps support movement without changes in the postural support devices.
- Postural changes help support functions such as respiration, digestion, peer engagement and fatigue management, to name a few.
- All secondary positioning supports attached to the thoracic segment move in unison with the body, eliminating the need for repositioning events.

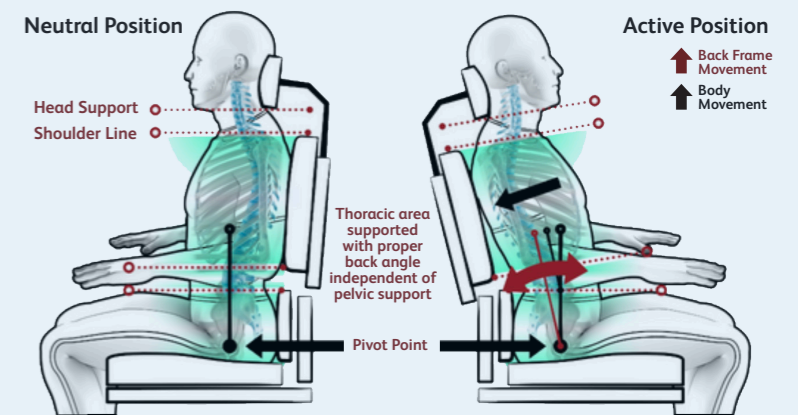

More information available here!



What's in The EPiC Seating Kit?

The new seating postural management system

- **Quick Adjustment Lever:** Adjust posterior thoracic support angle without the need of additional tools.
- **Telescopic 1" (2.5cm) back mounting canes:** with height adjustable handles. The handle's cane is 7/8" (2.2cm).
- **Gas Struts:** Provide resistance to support the client's movement and return to neutral. Available in 50 or 100 Newton resistance levels.
- **Pivot Point:** Movement is based on a virtual anatomical pivot point, helping to greatly reduce shear and eliminating the need to reposition the client and/or secondary positioning supports.

Resistance Levels:

- 50 N - Ideal for clients with limited active movement or posterior pelvic tilt.
- 100 N - Ideal for clients with normal to highly active movement.

Back Support Fittings:

- **Back Supports:** Any after-market back support is usable with to EPiC Seating. Back support size selection should take into consideration the height of the pelvic support plus an additional 2" (5cm) to provide proper clearance for movement to occur.
- **Back Support Mounting Hardware:** EPiC Seating is compatible with 1" back support mounting hardware.

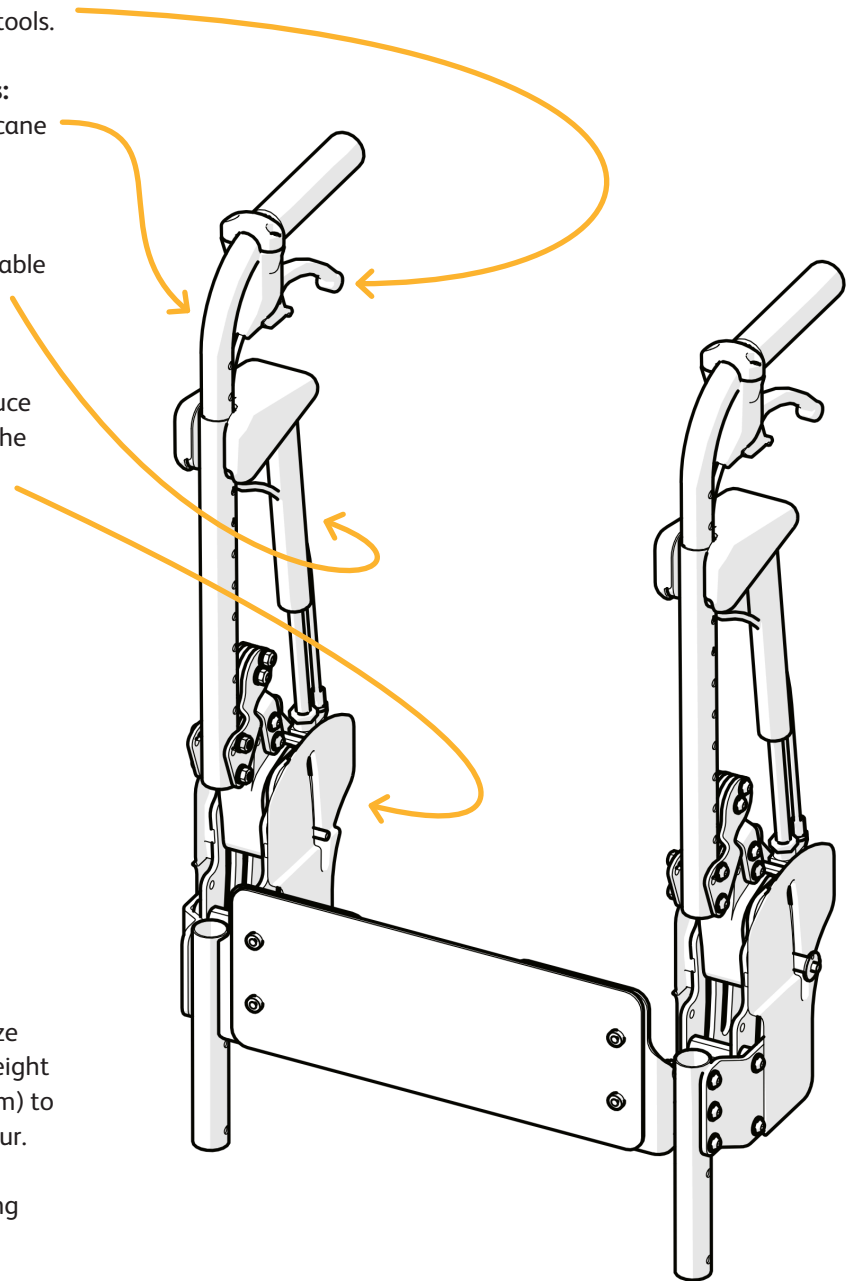

Get in touch with our helpful team for more information, demonstrations and to view the current compatible frame options available for the EPiC Seating.



B | E | S
HEALTHCARE

0117 966 6761
info@beshealthcare.net
www.beshealthcare.net

Supporting your needs

© 2024 BES Healthcare EOE BES003-07/24-V1